

 **WARNING**

PRODUCT MUST BE INSTALLED BY A QUALIFIED ELECTRICIAN
PLEASE READ ALL INSTRUCTIONS BEFORE ATTEMPTING INSTALLATION AND USE

- To reduce the risk of death, personal injury, or property damage from fire, electric shock, falling parts, cuts/abrasions, and other hazards, read all warnings and instructions included with this fixture, including on the fixture box and fixture labels.
- Before installing, servicing, or performing routine maintenance upon this fixture, follow these general precautions.
- Commercial installation, service, and maintenance of luminaires should be performed by a qualified licensed electrician.
- If you are unsure about the installation or maintenance of the luminaires, consult a qualified licensed electrician. Please abide by all relevant country, regional, and local code requirements and regulations when installing this luminaire. Wiring must be in accordance with NEC and all applicable local codes.
- **DO NOT INSTALL DAMAGED PRODUCT.** This luminaire has been properly packed so that no parts should have been damaged during transit. Inspect to confirm. Any part damaged or broken during or after assembly should be replaced.
- Do not make or alter any holes unnecessarily in an enclosure of wiring or electrical components during the installation.
- Turn off electrical power at the fuse or circuit breaker box before wiring fixture to the building power.
- Verify that supply voltage is correct by comparing it with the luminaire label information. Do not install with supply voltage that exceeds the rated input voltage of the luminaire.
- **DO NOT INSTALL IN WET LOCATIONS. FOR DRY AND DAMP USE ONLY.**
- **DISCONNECT OR TURN OFF POWER BEFORE INSTALLATION OR SERVICING.**
- **THE ELECTRICAL RATING OF THIS PRODUCT IS 120-277V. INSTALLER MUST CONFIRM THAT THE VOLTAGE AT THE INTENDED INSTALLATION LOCATION IS 120-277V BEFORE INSTALLATION.**
- **UNDER NO CIRCUMSTANCES CAN THE LIGHTING FIXTURE BE COVERED WITH HEAT INSULATION GASKET OR SIMILAR MATERIALS.**

Installation Guide

Always turn off the power supply from main circuit breaker before installing.

It is recommended to set Power, CCT, and Up/Downlight to the desired settings before installation.

Power / CCT / Up/Downlight Adjustment Controls - Included On All Models

Power, color temperature, and up/downlight may be set using a set of sliding dip switches on the top of the fixture housing.

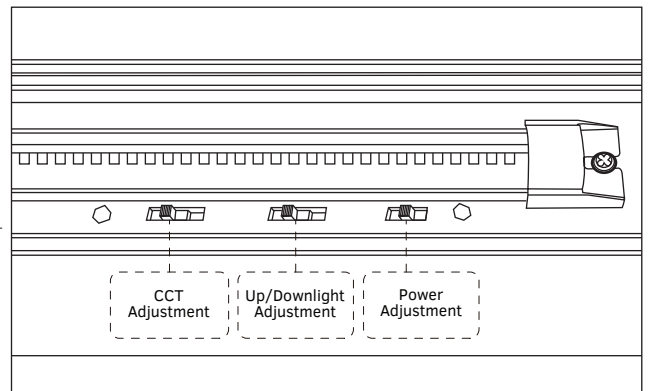
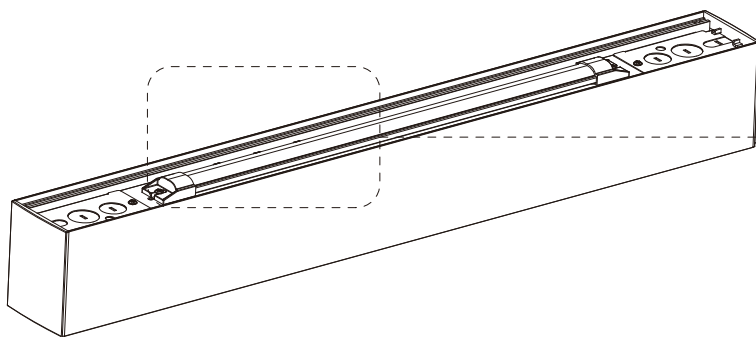
CCT Settings

50K | 40K | 35K | 30K | 27K

Up/Downlight Settings

100% ▲ | 75% ▲ | 50% ▲ | 25% ▲ | 0% ▲
 0% ▼ | 25% ▼ | 50% ▼ | 75% ▼ | 100% ▼

Power Settings

2FT	10W	15W	20W
4FT	20W	30W	40W
8FT	40W	60W	80W

Connections Between Fixtures With Metal Connector Bracket - Optional (Brackets Sold Separately)

If connections are needed for the project, connect all fixtures prior to mounting.

Multiple fixtures may be connected in a row using metal connector brackets. One bracket is needed for every connection and includes the parts below:

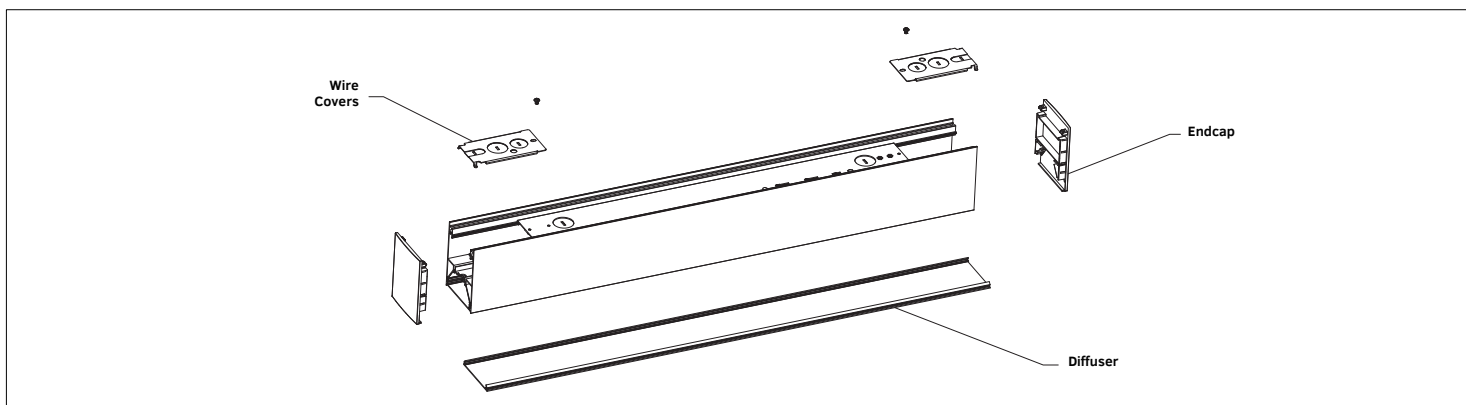
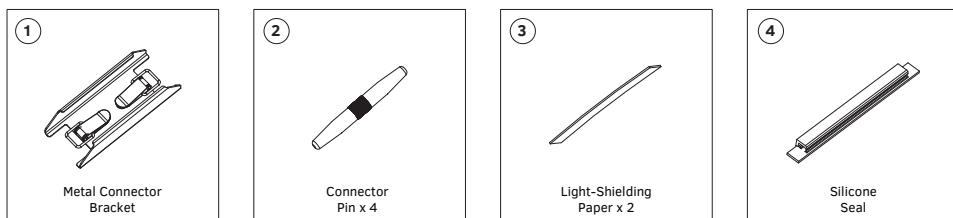

1. Remove the endcaps and wire covers from the sides being connected on every fixture being connected. Also remove the fixture diffusers.

IMPORTANT: Every fixture has a female power feed side (which may be marked with a power feed side sticker) and a male side. Connections may only be made between a female side on one fixture and a male side on the other.

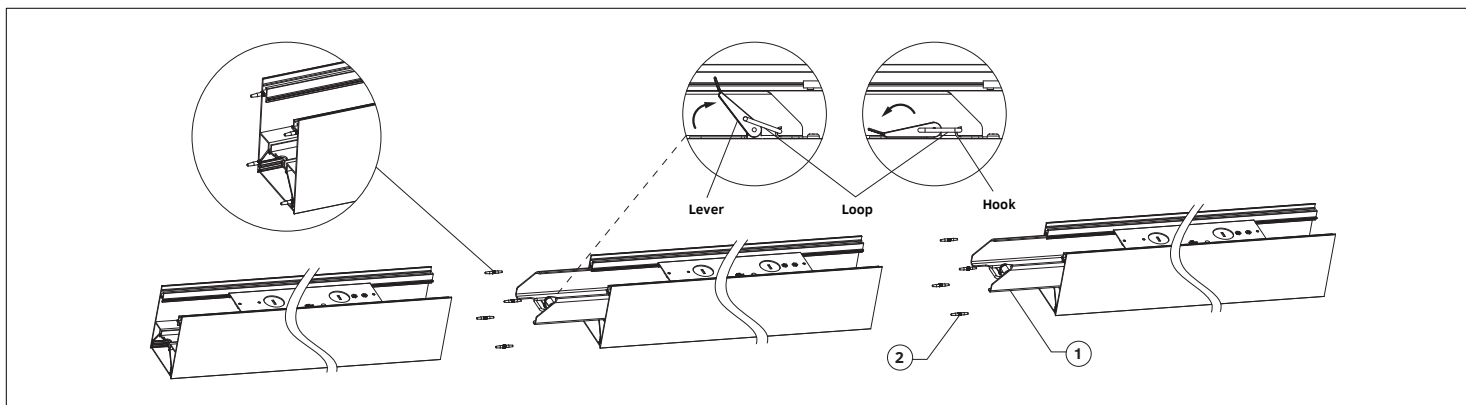

2. Insert the pins into the fixtures on the sides being connected, then insert the metal connector bracket and splice the fixtures together. To secure the connection, lift the lever from the metal connector bracket until the loop latches on to the hook on the fixture, then push the lever down again. Repeat on the other side.

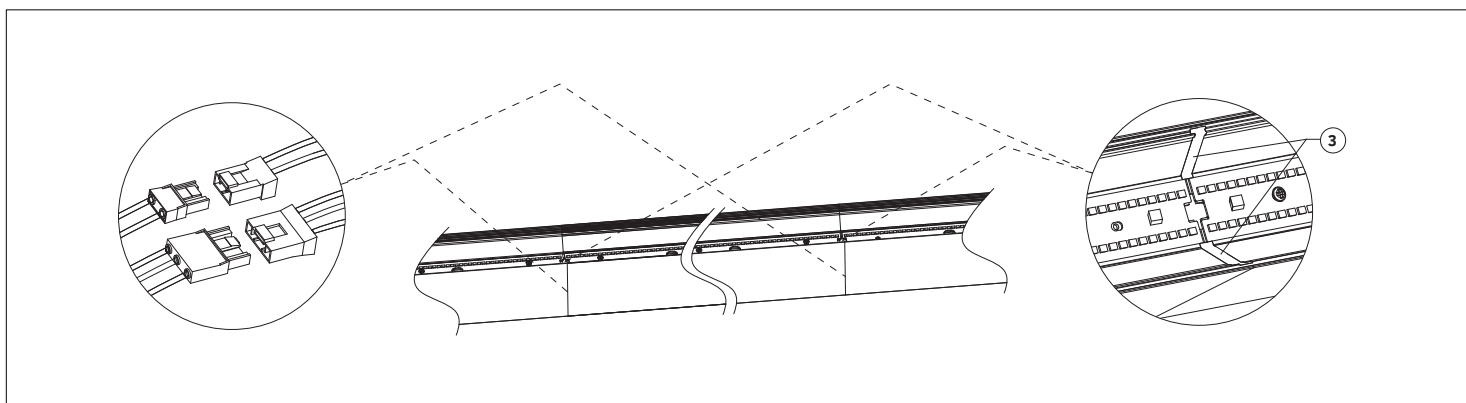

3. Connect the male and female terminals of the fixtures being connected, then apply the light-shielding paper to the gaps between the fixture housings.

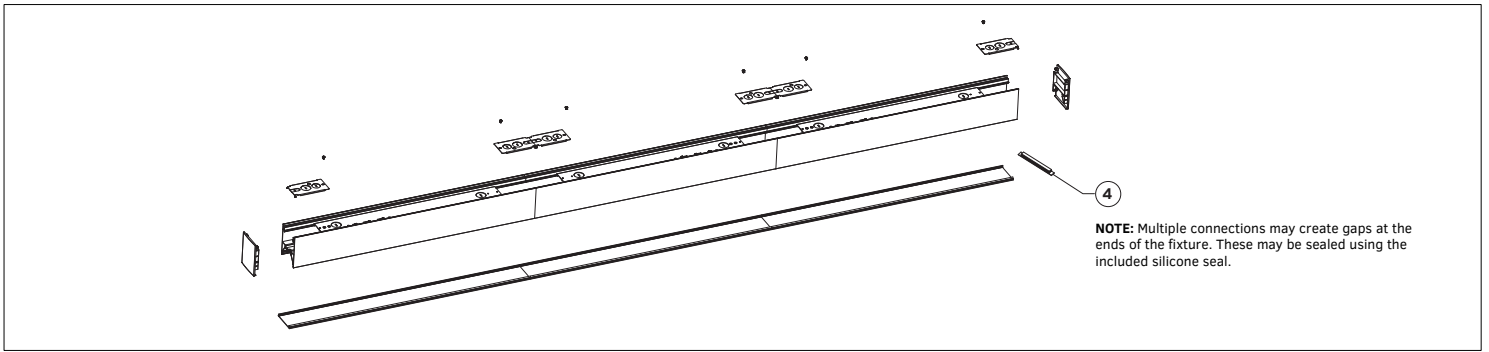

4. Replace all the wire covers, endcaps, and diffusers removed in step 1.

Connections Between Fixtures With Illuminated Connectors - Optional (Connectors Sold Separately)

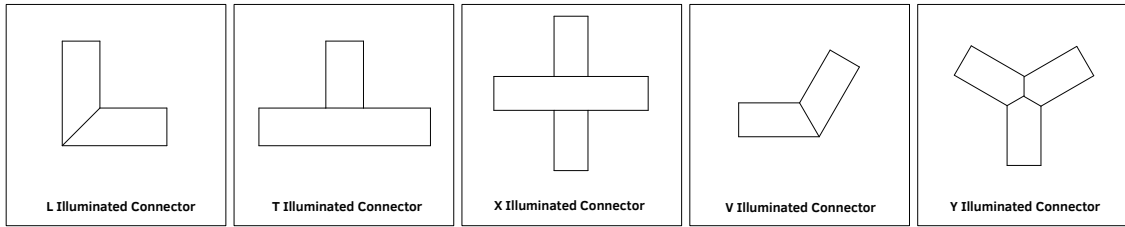

If connections are needed for the project, connect all fixtures prior to mounting.

Each illuminated connector includes 2, 3, or 4 metal connector brackets, as needed. Each bracket includes the parts below:

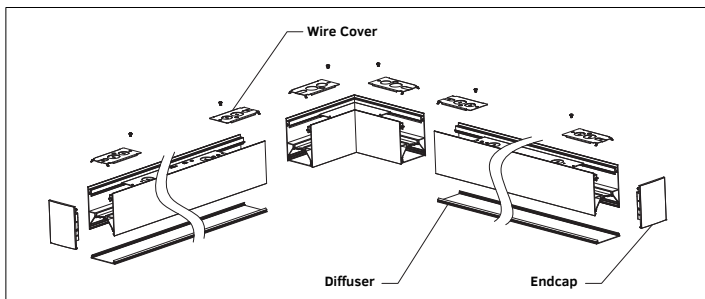
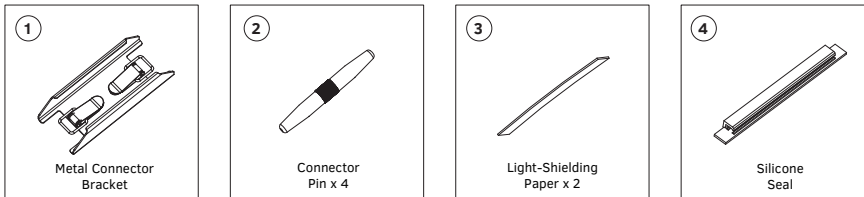

1. Remove the endcaps and wire covers from the sides being connected on every fixture being connected, as well as the fixture diffusers. Also remove the wire covers of the illuminated connector being used.

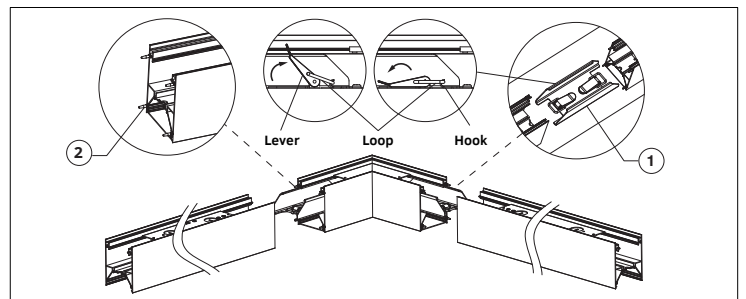

2. Insert the pins into the fixtures on the sides being connected, then insert the metal connector brackets and splice the fixtures together with the connectors. To secure the connection, lift the lever from the metal connector bracket until the loop latches on to the hook on the fixture, then push the lever down again. Repeat on the other side.

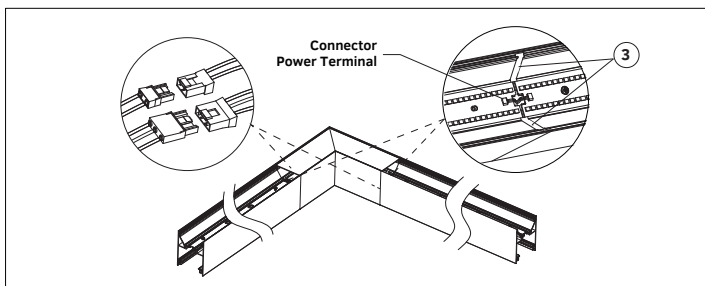

3. Connect the male and female terminals on all sides inside the fixtures, then connect all the connector power terminals to the fixture LED boards and tuck in the wires. Apply the light-shielding paper to the gaps between the fixture housings and the connectors.

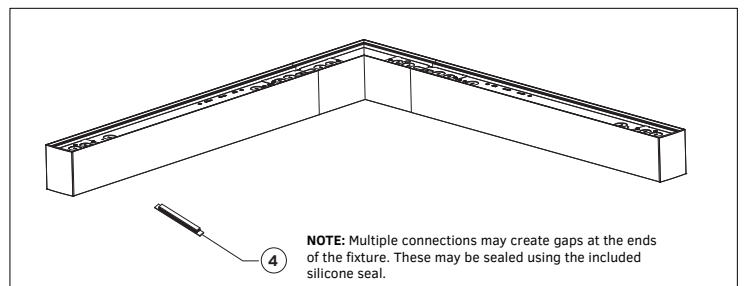

4. Replace all the wire covers, endcaps, and diffusers removed in step 1.

Drywall Pendant Mounting

Drywall Pendant Mounting - Included Components

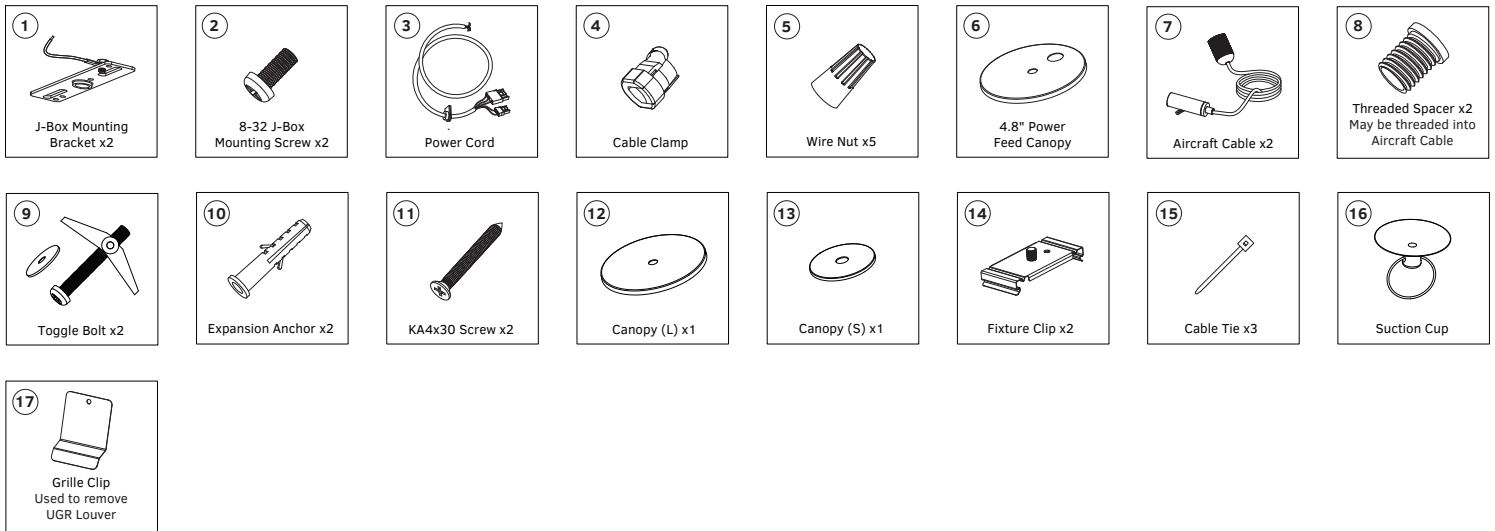

Drywall Pendant Mounting - Suggested Spacing

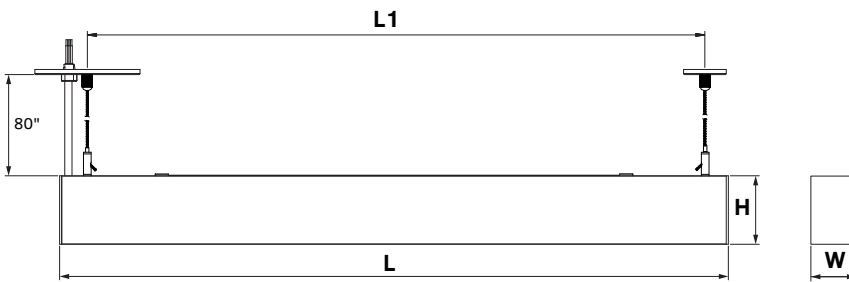

Size	L	W	H	Suggested Installation Spacing (L1)
2FT	23.82"	2.48"	3.15"	14.17" - 22.05"
4FT	47.44"	2.48"	3.15"	37.80" - 45.67"
8FT	94.67"	2.48"	3.15"	85.03" - 92.91"

Length of mounting cable is a maximum of 80".

Drywall Pendant Mounting - Directions

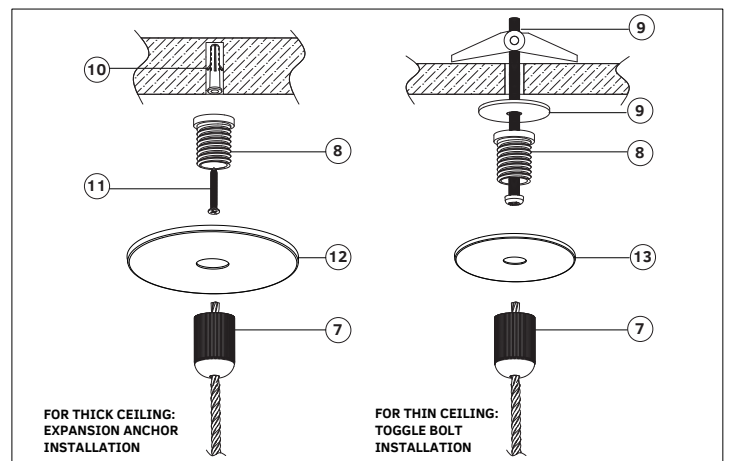
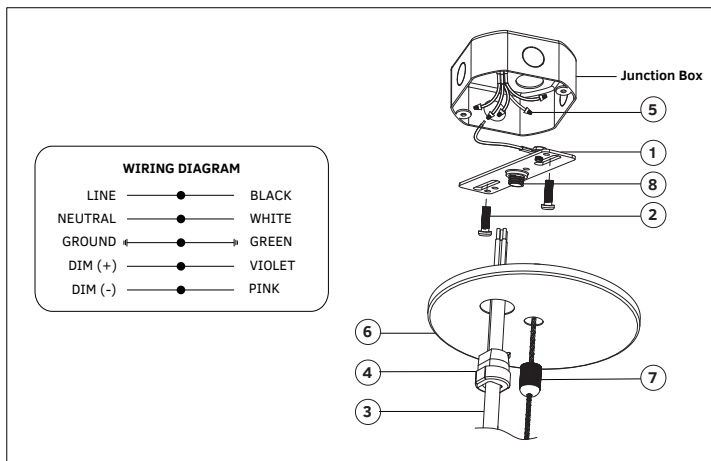

1. Thread the threaded spacer (8) through the hole in the middle of the mounting bracket (1), ensuring the threaded end of the spacer is on the side with the lip. Secure the mounting bracket (1) to the junction box with the two 8-32 mounting screws (2).
2. Feed the power cord (3) through the cable clamp (4) and through the canopy (6) and complete the wiring according to the wiring diagram.
3. Carefully tuck all connected wires into the junction box, push the canopy (6) up so that the threaded spacer (8) goes through the hole in the center, then tighten the locknut of the aircraft cable (7) onto the exposed threaded spacer (8).

4. The second aircraft cable (7) may be installed using either an expansion anchor (10) or a toggle bolt (9). Use the Suggested Spacing section above to determine the appropriate distance, then mark the position for the canopy (12) or (13) on the ceiling.
5. Secure the threaded spacer (8) to the ceiling using an expansion anchor (10) and KA4x30 screw (11) or toggle bolt (9).
6. Feed the canopy (12) or (13) through the threaded spacer (8), then tighten the locknut of the aircraft cable (7) onto the exposed threaded spacer (8).

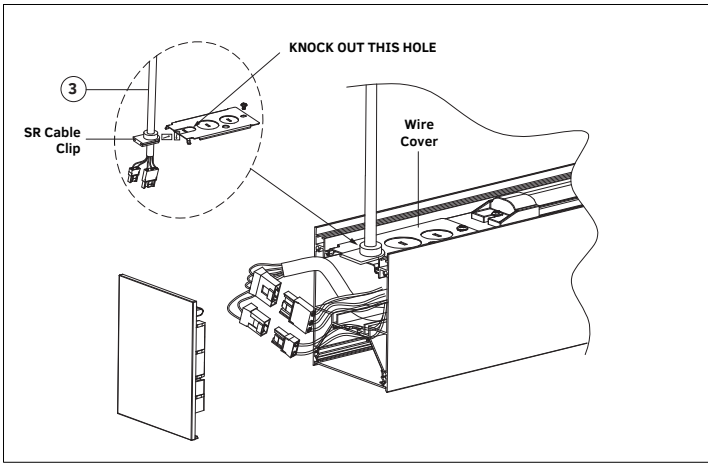

- There is one set of female wire terminals and one set of male wire terminals on opposite sides of the fixture. The power feed is on the side with the female terminals and may be marked by a sticker. If not, identify where each is located (the endcaps may be removed to make this easier) and mark them on the wire cover.
- Loosen the screws and remove the endcap from the female side of the fixture, remove the wire cover, knock out the designated knockout hole, and reinstall the wire cover.
- Clip the SR cable clip of the power cord (3) into the U-shaped groove created by knocking out the designated knockout hole and connect the wire terminals as indicated in the image.
- Carefully tuck all wires into the luminaire and reinstall the endcap.

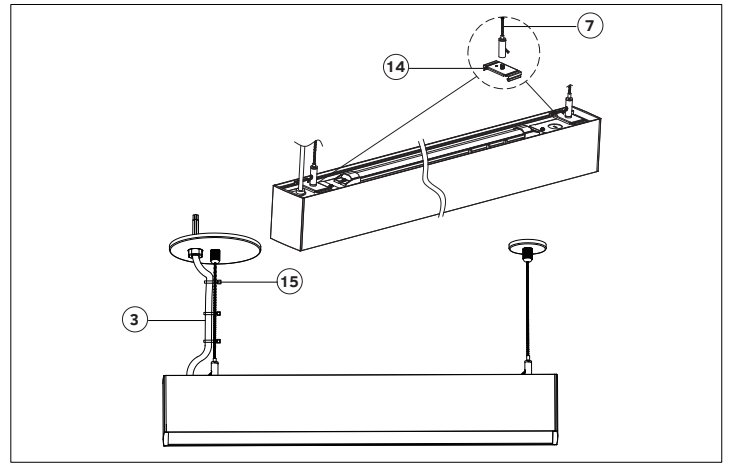

- Attach the two fixture clips (14) to the fixture.
- Attach the aircraft cables (7) to the fixture clips (14).
- Adjust the length of the aircraft cable (7) by pulling the bare end of the aircraft cable through the exit hole of the gripper. If the cable has been made too short, length can be reclaimed by carefully unscrewing the top of the gripper and pulling the cable back out.
- Secure power cord (3) cable slack to the aircraft cable (7) using the color-matched cable ties (15).

Surface Mounting

Surface Mounting - Included Components

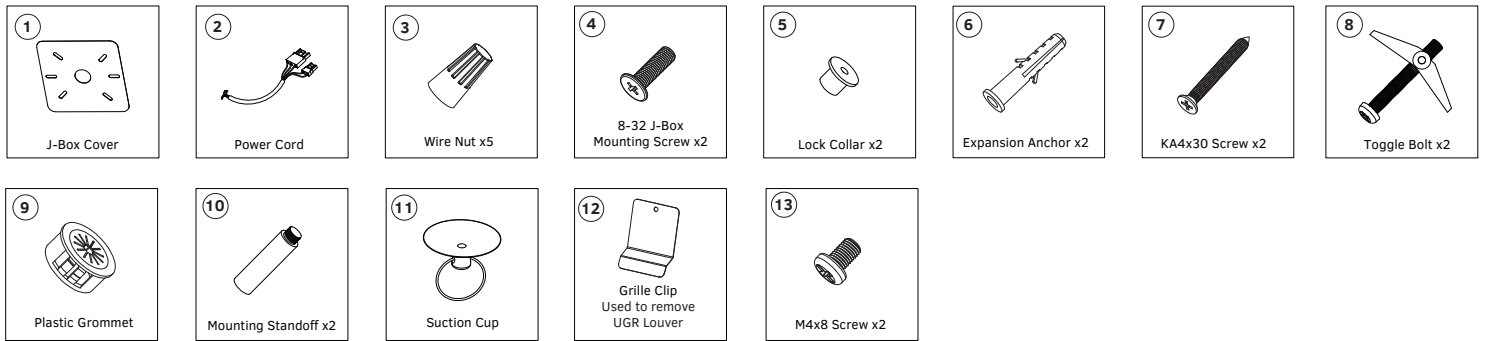

Surface Mounting - Suggested Spacing

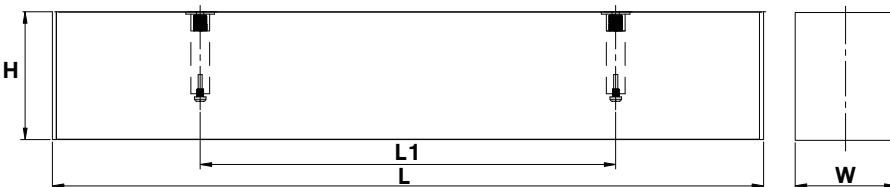

Size	L	W	H	Suggested Installation Spacing (L1)
2FT	23.82"	2.48"	3.15"	14.17"
4FT	47.44"	2.48"	3.15"	37.80"
8FT	94.67"	2.48"	3.15"	85.03"

Surface Mounting - Complete Schematic Diagram

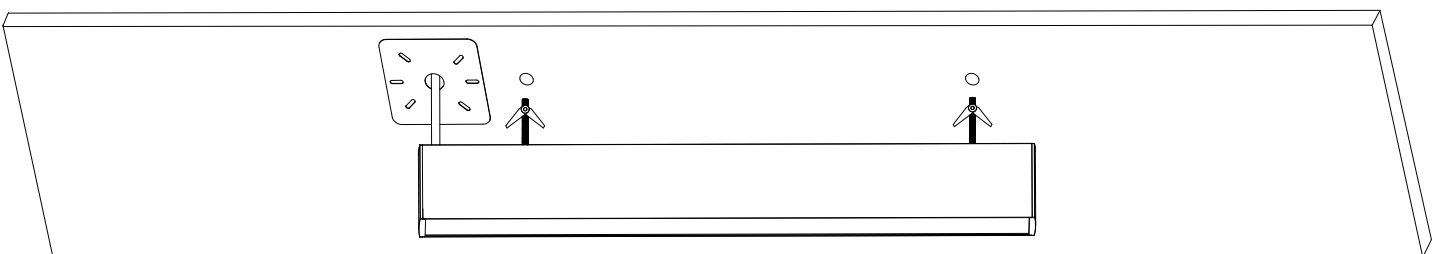

Surface Mounting - Directions

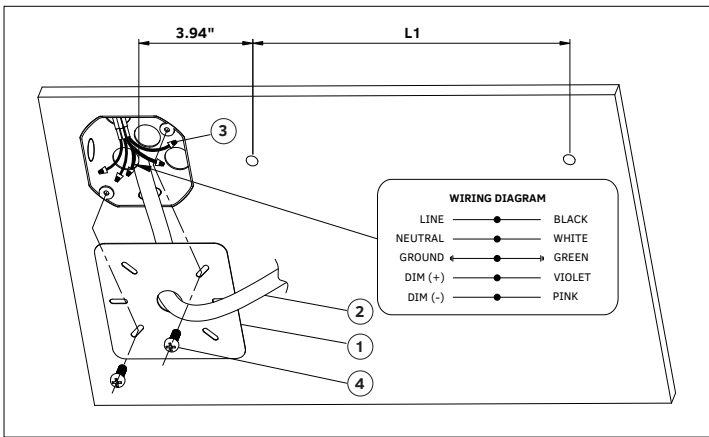

1. **IMPORTANT:** GKOLED product comes standard with a pre-installed uplighting module attached with 2 screws and adhesive backing paper. This module uses the holes required by the surface mounting kit and must be removed prior to surface mounting.

To remove the module, first remove the wire covers and disconnect the white uplighting connectors. 2ft and 4ft models use one connector on the side opposite the power feed, 8ft models use two connectors, one on each side of the module. Then, remove the screws holding the module in place and carefully pull the module up from the adhesive backing paper.

Refer to the Suggested Spacing section on the previous page to determine the installation locations for the 2 lock collars used to secure the fixture to the ceiling. Drill 2 holes as indicated, with the first hole 3.94" from the center of the junction box. For ceilings up to 5/8", make 1/2" holes for toggle bolts. For thicker ceilings, make 1/4" holes for expansion anchors. If using a 4" J-box, feed the power cord (2) through the central hole of the J-box cover (1) and make wiring connections with the wire nuts (3). Fasten the J-box cover (1) to the J-box with the 8-32 screws (4). If using a 2x4" J-box, omit the J-box cover and wire directly into J-box.

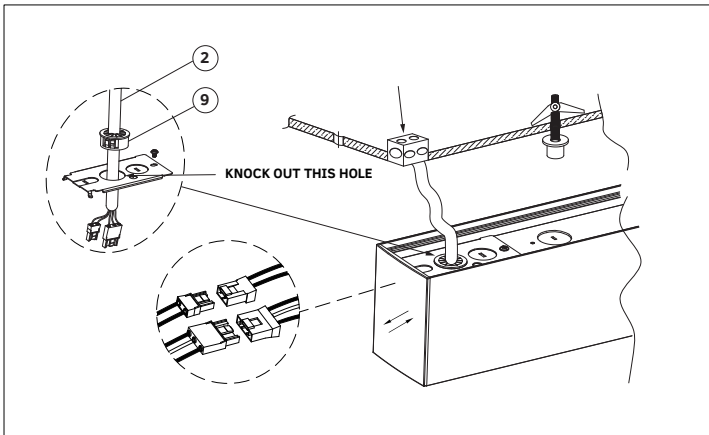

3. There is one set of female wire terminals and one set of male wire terminals on opposite sides of the fixture. The power feed is on the side with the female terminals and may be marked by a sticker. If not, identify where each is located (the endcaps may be removed to make this easier) and mark them on the wire cover.
4. Loosen the screws and remove the endcap from the female side of the fixture, remove the wire cover, and knock out the designated knockout hole.
5. Feed the power cord (2) supply wires through the plastic grommet (9) and the knockout hole in the wire cover. Insert the plastic grommet into the hole. Connect the wire terminals as indicated in the image, then carefully tuck all wires into the luminaire and reinstall the endcap and wire cover.

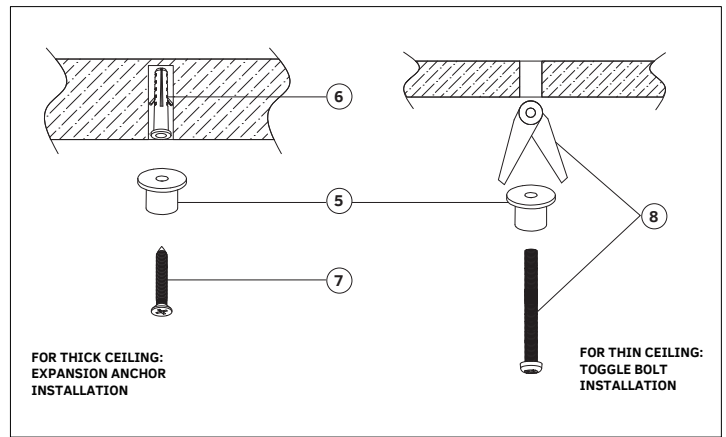

2. Secure the lock collars (5) to the holes drilled in the previous step using the expansion anchors (6) and KA4x30 screws (7) or toggle bolts (8).

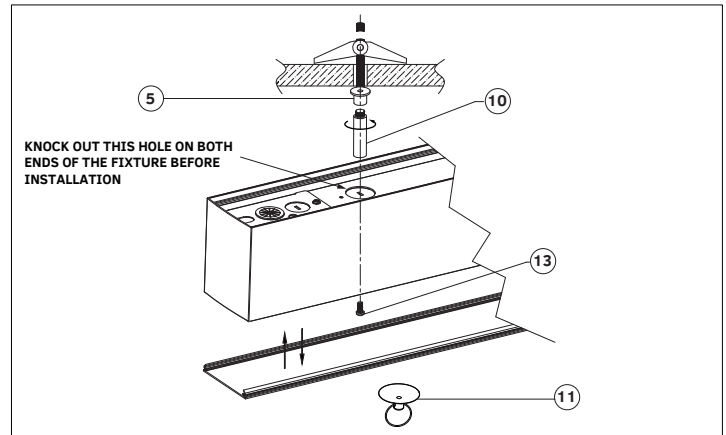

6. Knock out the indicated knockout holes on both ends of the fixture and tightly screw the two mounting standoffs (10) onto the two installed lock collars (5).
7. Use the suction cup (11) to remove the diffuser and secure the fixture body to the mounting standoffs (10) using the two M4x8 locking screws (13). Replace the diffuser to finish installation.

Wall Mounting

Wall Mounting - Included Components

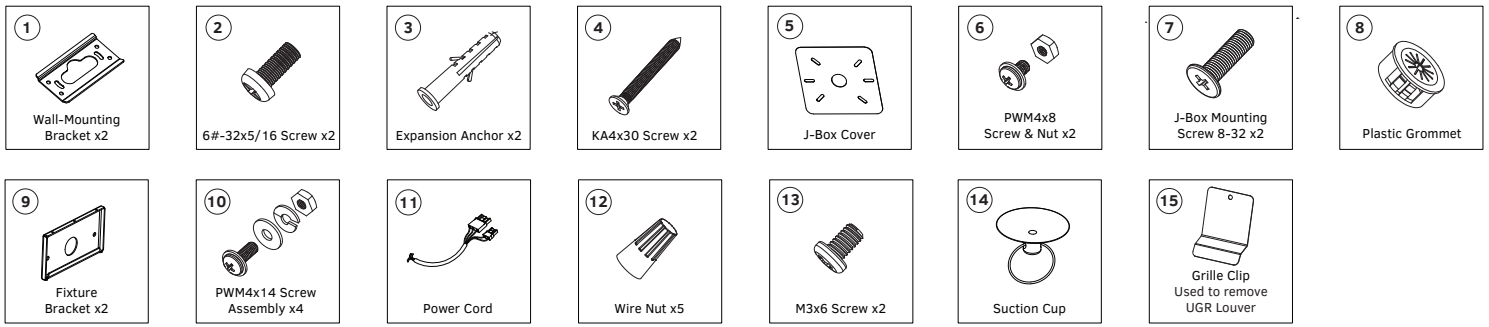

Wall Mounting - Suggested Spacing

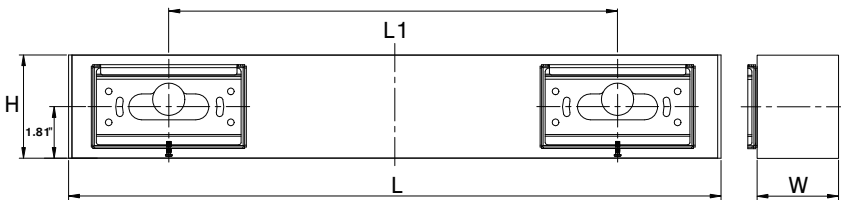

Size	L	W	H	Suggested Installation Spacing (L1)
2FT	23.82"	2.48"	3.15"	13.78"
4FT	47.44"	2.48"	3.15"	41.33"
8FT	94.67"	2.48"	3.15"	88.58"

Wall Mounting - Directions

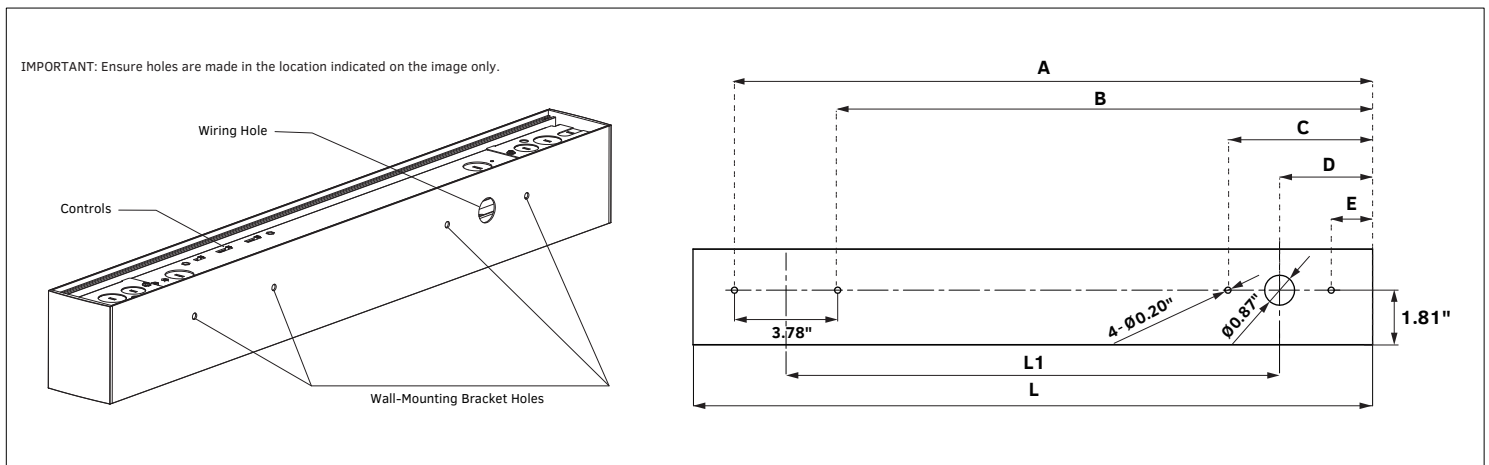

1. Refer to the Hole Positioning Guide table below to determine positioning, then machine the wiring hole and four wall-mounting bracket holes as indicated in the image and diagram. A high quality cobalt step drill bit is suggested for this step. **IMPORTANT: Ensure holes are made in the location indicated on the image only and take care not to damage the internal wiring and components.**

Hole Positioning Guide

Size	L	L1	A	B	C	D	E
2FT	23.82"	13.78"	20.69"	16.91"	6.91"	5.02"	3.13"
4FT	47.44"	41.33"	46.27"	42.49"	4.94"	3.05"	1.16"
8FT	94.67"	88.58"	93.52"	89.74"	4.94"	3.05"	1.16"

IMPORTANT: Distances A, B, C, D, and E should be measured from the edge of the fixture to the center of the indicated hole.

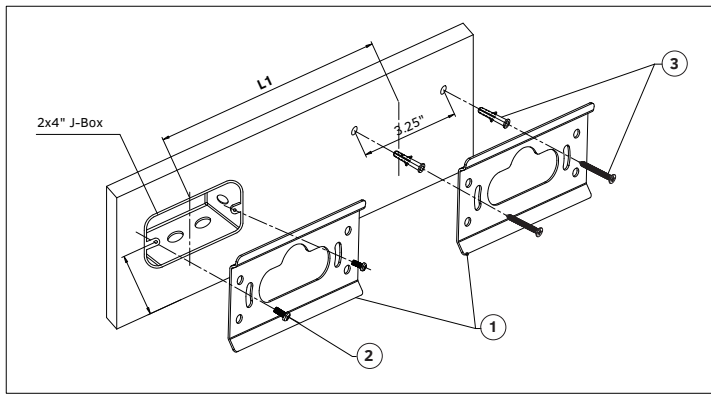

- 2a. If installing with a 2x4" J-Box, attach a wall-mounting bracket (1) directly to the J-Box with 6#-32x5/16 screws (2).
- b. Drill holes in the wall as indicated, then use the expansion anchors and KA4x30 screws (3) to attach the second wall-mounting bracket (1) to the wall.

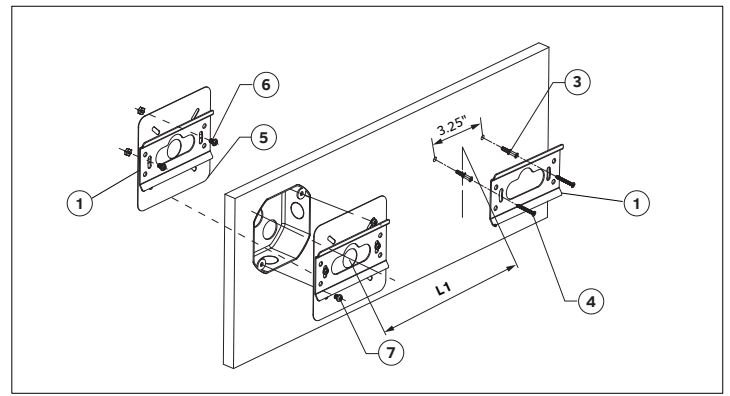

- 2a. If installing with a 4" J-Box, attach a wall-mounting bracket (1) onto the J-Box cover (5) using the PWM4x8 screws and nuts (6), then attach the J-Box cover (5) to the J-Box using the J-Box mounting screws (7).
- b. Drill holes in the wall as indicated, then use the expansion anchors and KA4x30 screws (3) to attach the second wall-mounting bracket (1) to the wall.

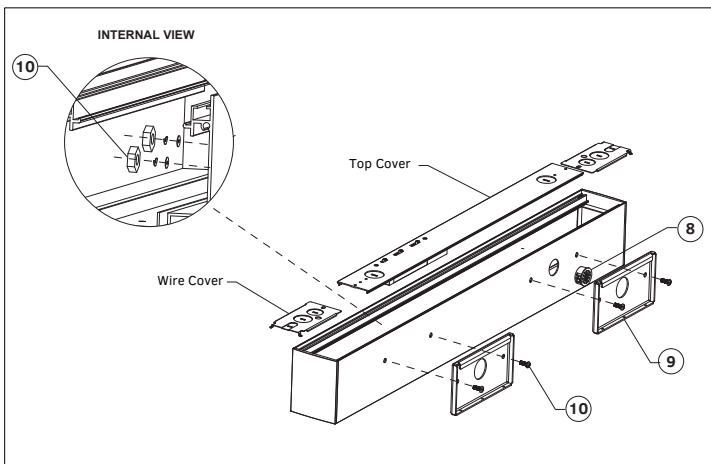

3. Remove the top cover (with the driver) as well as the two wire covers. Insert the plastic grommet (8) into the wiring hole, then use the PWM4x14 screw assemblies (10) to attach the fixture brackets (9) to the fixture body.

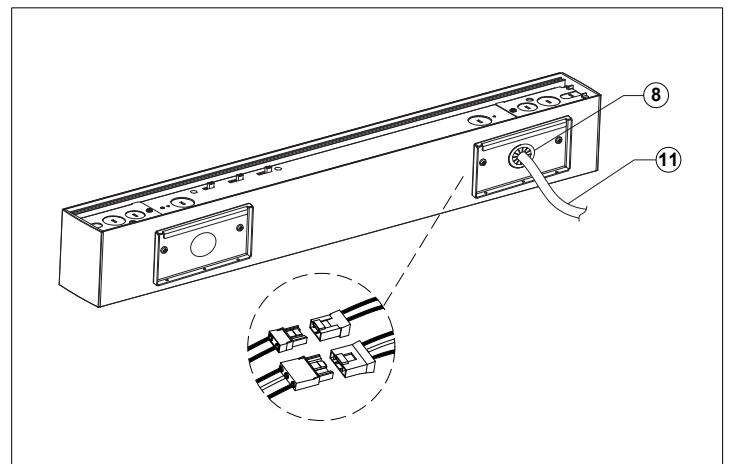

4. Insert the power cord (11) into the fixture through the plastic grommet (8). Connect the power cord wire terminals to the fixture power terminals as indicated then replace the top cover (with the driver) and the two wire covers.

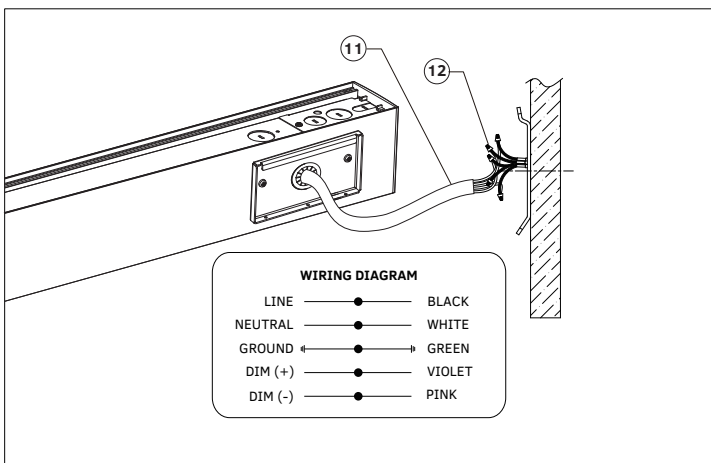

5. Connect the power cord (11) wires to mains power as shown in the wiring diagram and secure connections with wire nuts (12).

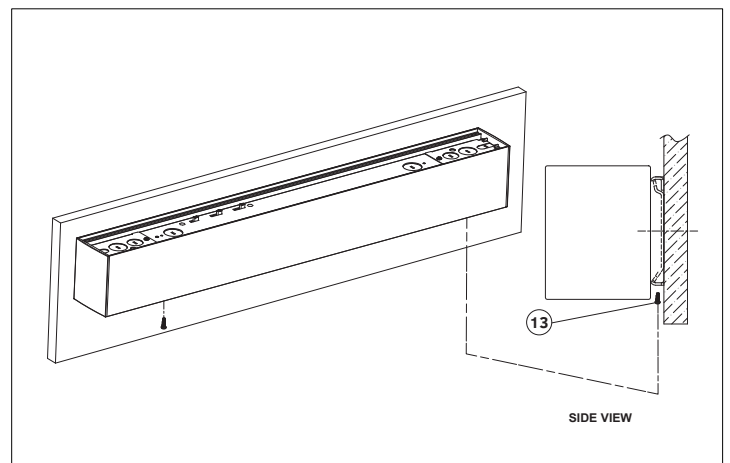

6. Fully snap the fixture brackets into the wall mounting brackets and use the M3x6 screws (13) to secure the fixture brackets to the wall mounting bracket, as shown.